

FireLock® Devices

SERIES 757P AIR MAINTENANCE TRIM ASSEMBLY

AIR MAINTENANCE TRIM

Bill of Materials

Item	Qty.	Description
1	1	Restrictor (½-inch NPT)
2	1	Strainer (½-inch NPT)
3	1	Swing Check (½-inch NPT)
4	1	Slow-Fill Ball Valve (Normally Open)
5	1	Spring-Loaded, Soft-Seated Check Valve
6	1	Pressure Switch
7	2	Compression Fitting, Straight (¼-inch NPT x ¼-inch Tube)
8	1	Copper Tubing (¼-inch OD)
9	11	Close Nipple (½-inch NPT x 1.13)
10	1	Nipple (½-inch NPT x 4.00)
11	1	90° Female Elbow (½-inch NPT)
12	4	Female Tee (½-inch NPT)
13	3	Union (½-inch NPT)
14	2	Reducing Bushing (½-inch NPT x ¼-inch NPT)
15	1	Fast-Fill Ball Valve (Normally Closed)
16	1	Pressure Switch Isolation Ball Valve (Normally Open - Lockable)

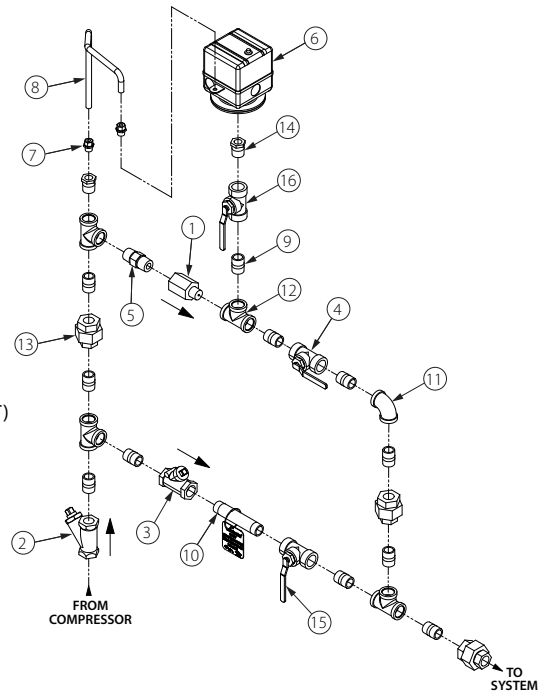

NOTES:

The Series 757P Air Maintenance Trim Assembly is designed to control system air pressure for Series 768 FireLock NXT™ Dry Valves, Series 764 FireLock NXT Alternate Wet/Dry Valves, and Series 769 FireLock NXT Deluge and Preaction Valves (pneumatic systems).

A decrease in air pressure will close the pressure switch. When the pressure switch closes, the air compressor turns on to restore air pressure. When air pressure is restored, the air compressor turns off, and pressure in the compressor automatically bleeds off through the release valve of the pressure switch. The release valve protects the air compressor from startup overload.

NOTICE

Victaulic recommends a maximum of two FireLock NXT Valves per Series 757P Air Maintenance Trim Assembly with Pressure Switch.

The required air pressure for Series 768 FireLock NXT Dry Valves, Series 764 FireLock NXT Alternate Wet/Dry Valves, and Series 769 FireLock NXT Deluge and Preaction Valves is 13 psi/0.9 Bar minimum, regardless of the system supply water pressure. Normal air pressure should not exceed 18 psi/1.2 Bar. Air pressure higher than the required system air pressure could delay system operation response time.

The Series 757P Air Maintenance Trim Assembly with Pressure Switch MUST NOT be used on a Series 768 or Series 769 FireLock NXT Valve installed with a Series 746 or Series 746-LPA Dry Accelerator, unless a tank and air regulator are added.

The engineer/system designer is responsible for sizing the compressor so that the entire system is charged to the required air pressure within NFPA guidelines (30 minutes). DO NOT oversize the compressor to provide more airflow. An oversized compressor will slow down or possibly prevent valve operation.

FireLock® Devices

SERIES 757P AIR MAINTENANCE TRIM ASSEMBLY

AIR MAINTENANCE TRIM CONTINUED

