

All installations and services must be performed by qualified service personnel.

APPENDIX A – REPLACEMENT PARTS

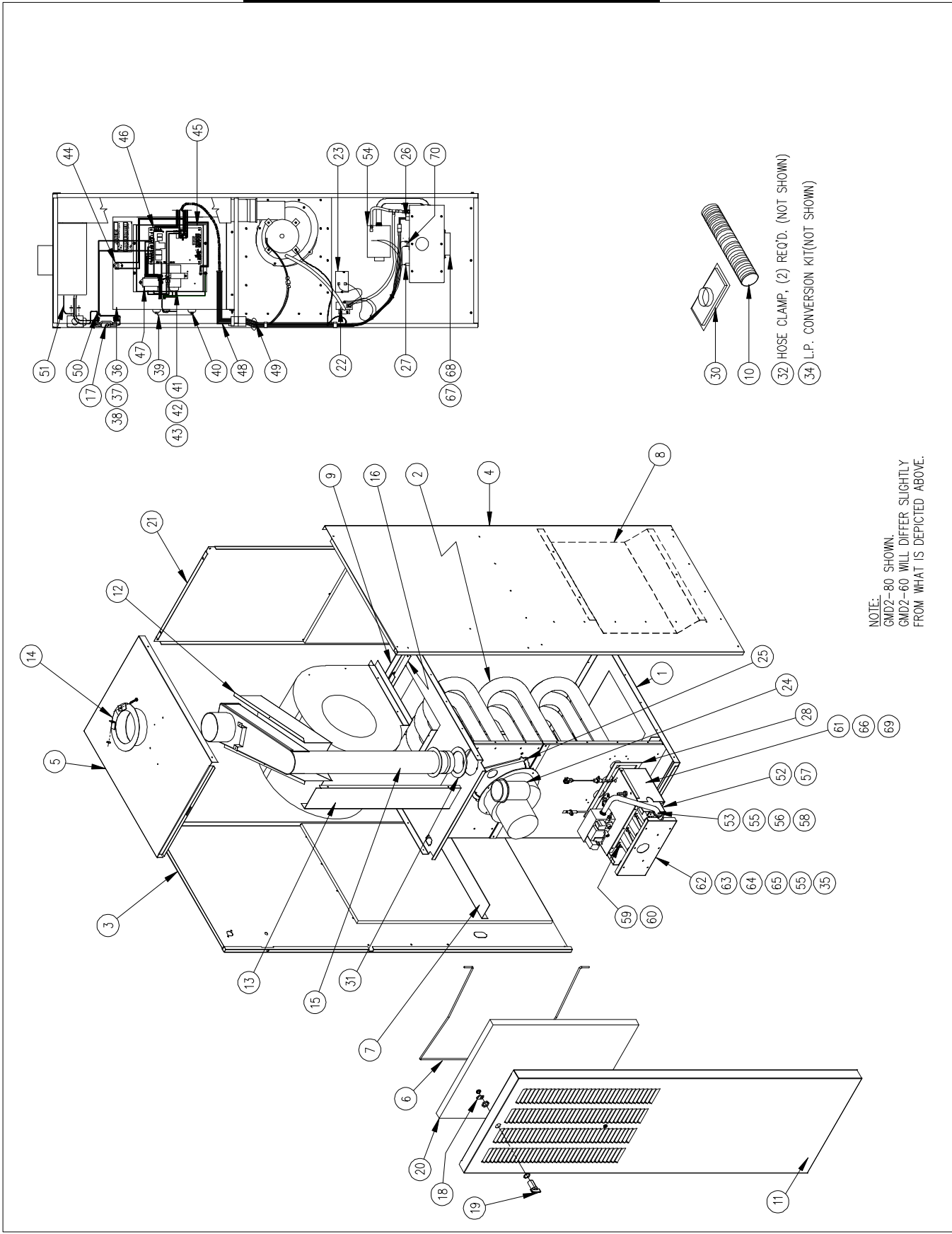

All installations and services must be performed by qualified service personnel.

ITEM	PARTS DESCRIPTION	UNIT	GMD2-60N		GMD2-80N	
			PART NO.	QTY.	PART NO.	QTY.
1	BASE		18188	1	18188	1
2	HEAT EXCHANGER		38694	1	38191	1
3	SIDE CASING, LEFT		619002	1	619002	1
4	SIDE CASING, RIGHT		619003	1	619003	1
5	TOP		618973	1	618973	1
6	FILTER RETAINER ROD		14809	1	14809	1
7	BAFFLE, SIDE		18701	1	18195	1
8	BAFFLE, SIDE		18702	1	18186	1
9	BLOWER PAN		18190	1	18190	1
10	FLEX HOSE		11239	1	11239	1
11	FRONT DOOR		618929	1	618929	1
12	FLUE COVER, TOP		18711	1	18293	1
13	FLUE COVER		18710	1	18201	1
14	DRAW COLLAR		624100	1	624100	1
15	FLUE CONNECTOR ASSEMBLY		38708	1	38230	1
16	BAFFLE, BLOWER PAN		18703	1	18328	1
17	DOOR SWITCH		350262	1	350262	1
18	—		—	—	—	—
19	CAM LATCH ASSEMBLY		50043	1	50043	1
20	FILTER		370192	1	370192	1
21	REAR CASING		619004	1	619004	1
22	PRESSURE SWITCH		350483	1	350483	1
23	HIGH LIMIT SWITCH		350495	1	AOPS2678	1
24	INDUCER w/ GASKET		AOPS7432	1	AOPS7432	1
25	INDUCER GASKET		330181	1	330181	1
26	IGNITOR		380771	1	380771	1
27	SENSOR		350759	1	350759	1
28	GASKET, BURNER BOX		330331	1	330189	1
29						
30	INLET PLATE		320807	1	320807	1
31	GASKET, FLUE		330330	1	330187	1
32	HOSE CLAMP		300322	2	300322	2
—	NAT CONVERSION KIT		AOPS7697	1	AOPS7686	1
34	LP CONVERSION KIT		AOPS7696	1	AOPS7685	1
35	BLOCKOFF		18698	1	18034	1

ITEM	PARTS DESCRIPTION	UNIT	GMD2-60N		GMD2-80N	
			PART NO.	QTY.	PART NO.	QTY.
36	BLOWER SUB-ASSEMBLY		50055	1	50054	1
37	DIRECT DRIVE BLOWER w/ WHEEL		S00S4142	1	S00S4143	1
38	BLOWER WHEEL		340096	1	340083	1
39	MOTOR w/ CAPACITOR		AOPS7655	1	AOPS7655	1
40	MOTOR MOUNTING BRACKET		AOPS7670	1	AOPS7670	1
41	CAPACITOR INSULATING BOOT		350036	1	350036	1
42	CAPACITOR MOUNTING BRACKET		18000	1	18000	1
43	CAPACITOR		350073	1	350073	1
44	AUX. LIMIT SWITCH		350891	1	350891	1
45	CONTROL PANEL SUB-ASS'Y		S00S4459	1	S00S4459	1
46	INTEGRATED CONTROL		350211	1	350211	1
47	TRANSFORMER 24v		350405	1	350405	1
48	WIRE HARNESS, BLOWER		350638	1	350638	1
49	WIRE HARNESS, VESTIBULE		350489	1	350489	1
50	WIRE HARNESS, SUPPLY		350893	1	350893	1
51	WIRE HARNESS, GROUND		350892	1	350892	1
52	BURNER DRAWER SUB-ASSEMBLY		S00S8211	1	S00S8209	1
53	MANIFOLD		50029	1	50030	1
54	GAS VALVE		AOPS7674	1	AOPS7674	1
55	NAT. ORIFICE		380042	2	380617	3
56	GROMMET		360434	1	360434	1
57	BURNER BRACKET		18692	1	16016	1
58	BUSHING, REDUCER		320806	1	320806	1
59	BURNER TUBE		380595	3	380595	3
60	BURNER HOLDER		18693	1	16015	1
61	BURNER BOX SUB-ASSEMBLY		S00S8212	1	S00S8210	1
62	BURNER BOX COVER		18690	1	18033	1
63	SILICONE SPONGE GASKET, 1/2"		330141	23"	330141	28.5"
64	SIGHT GLASS GASKET		330135	1	330135	1
65	SIGHT GLASS		15887	1	15887	1
66	BURNER BOX TOP		18689	1	18193	1
67	AIR INLET ASSEMBLY		35908	1	35908	1
68	INLET FLANGE GASKET		330158	1	330158	1
69	BURNER BOX WRAP		18691	1	18194	1
70	ROLL-OUT SWITCH		350485	1	350485	1

All installations and services must be performed by qualified service personnel.

APPENDIX B – WIRING DIAGRAM

