



SERVICE PARTS LIST

BULLETIN NO.
PN0001448

SPECIFY CATALOG NO. AND SERIAL NO. WHEN ORDERING PARTS		REVISED BULLETIN	DATE
SIX BAY DAISY CHAIN M18™ RAPID CHARGER			May 2025
CATALOG NO.	48-59-1817	SERIAL NO.	P74A
WIRING INSTRUCTION			

EXAMPLE:

Component Parts (Small #)
Are Included When Ordering
The Assembly (Large #).

00
0

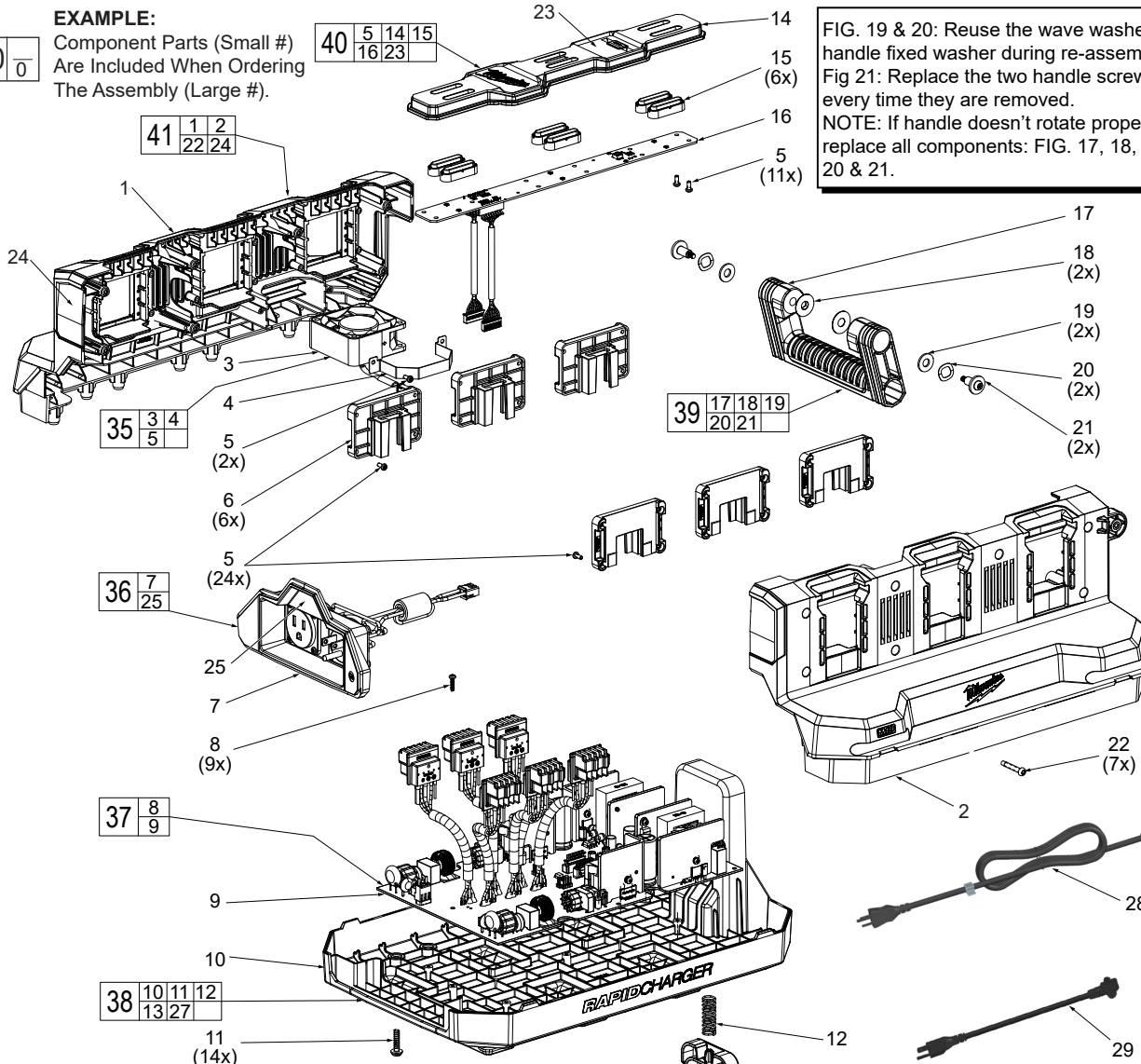

FIG. 19 & 20: Reuse the wave washer and handle fixed washer during re-assembly.
Fig 21: Replace the two handle screws every time they are removed.
NOTE: If handle doesn't rotate properly, replace all components: FIG. 17, 18, 19, 20 & 21.

FIG.	PART NO.	DESCRIPTION OF PART	NO. REQ.
1	-----	Top Housing - Left	(1)
2	-----	Top Housing - Right	(1)
3	-----	Fan Assembly	(1)
4	-----	Fan Bracket	(1)
5	06-82-0027	M3 x 7mm Pan Hd. T-10 Screw	(37)
6	-----	Terminal Block Holder	(6)
7	10-21-0145	Pass-through Badge Assembly	(1)
8	05-78-0044	M3 x 12mm Pan Hd. T-10 Screw	(9)
9	-----	Main Board	(1)
10	-----	Bottom Housing	(1)
11	06-82-8551	M5 Washer Pan Hd. T-25 Screw	(14)
12	-----	Spring	(1)
13	-----	Locker	(1)
14	10-21-0140	UI Badge	(1)
15	-----	LED Lens	(1)
16	-----	LED Board	(1)
17	14-34-1070	Rotating Handle	(1)
18	45-88-7190	PTFE Washer	(2)
19	45-88-7185	Fixed Washer	(2)
20	45-88-7180	Wave Washer	(2)
21	06-82-9285	M4 x 18.3mm Washer Pan Hd. T-20	(2)
22	06-82-8552	M4 x 25.4mm Pan Hd. T-20 Screw	(7)

FIG.	PART NO.	DESCRIPTION OF PART	NO. REQ.
23	10-22-2010	UI Label	(1)
24	10-22-3035	Warning Label (not shown)	(1)
25	10-22-3055	Front Label	(1)
27	12-20-6675	Service Nameplate (not shown)	(1)
28	42-38-0510	Power Cord UL	(1)
29	14-20-3210	Power Cord UL - 381mm	(1)
35	22-84-0995	Fan Service Kit	(1)
36	10-21-1545	Passthrough Badge Service Kit	(1)
37	14-20-3205	Main Board Service Kit	(1)
38	14-46-8055	Bottom Housing Kit	(1)
39	14-20-3210	Handle Service Kit	(1)
40	14-20-3225	UI & LED Board Service Kit	(1)
41	14-20-3220	Top Housing Service Kit	(1)